

2

3

4

5

6

7

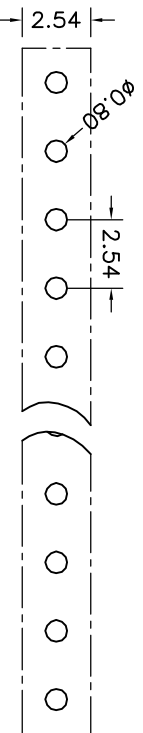
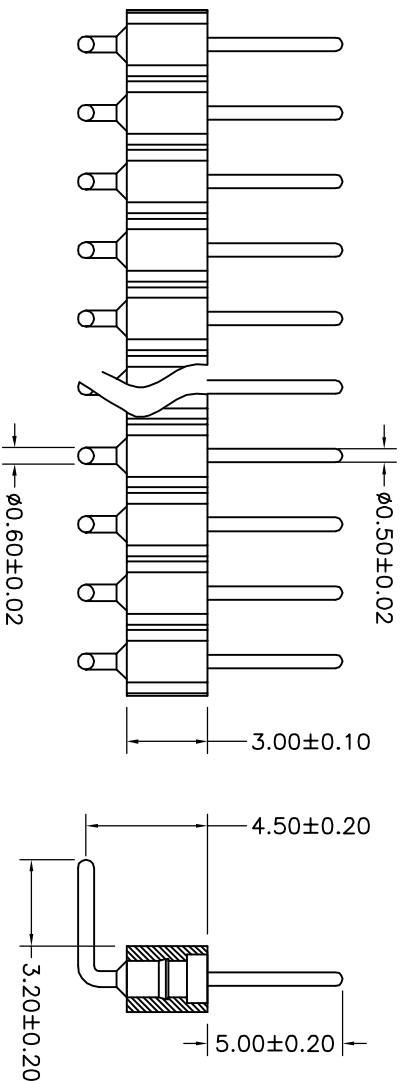
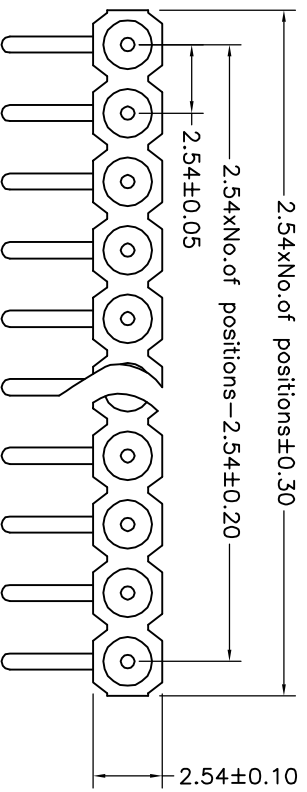

### P. C. B LAYOUT

REVISION DATA		DATE
REV	DESCRIPTION	
A0	NEW DRAWING	16-5-6

**Technical Data**  
**Material:**  
 Pin (outer sleeve): Brass, machined CuZn38Pb2  
 Plating (outer sleeve):  
 Tin Plated:  $2\mu\text{m}/80\mu\text{m}$  Ni,  $5\mu\text{m}/200\mu$  Sn  
 Gold Plated:  $2\mu\text{m}/80\mu\text{m}$  Ni,  $0.8\mu$  gold  
 Insulator: PPS UL94V-0

**Electrical:**  
 Current rating: 3Amps/contact max.  
 Contact resistance:  $\leq 4\text{m}\Omega$ /contact  
 Insulation resistance:  $\geq 1000\text{M}\Omega$  at V=100V  
 Dielectric Withstanding Voltage: 1000V AV Min  
 Operating voltage: 60VAC/DC

**Mechanical:**  
 Operating temperature:  $-40^\circ\text{C}$  to  $+105^\circ\text{C}$   
 Soldering temperature:  $+255^\circ\text{C}$

QZT	X	X	X	X	X
Pitch (mm) A=1.27 B=1.778 C=2.00 D=2.54	Insulator Type code 1=Single row 2=Double row 3=Three row	Angel Options D=180° R=90° S=SMT I=IC	No. of Positions XX positions	Pin Plated T1=Tin 150u" T2=Tin 200u" G1=6/F G2=gold 30u" G3=gold 10u" G4=gold 15u" G5=gold 30u"	Pin Length Options 1376=13.76mm
					Specifications A=Public seat B=Female seat

<b>uztconn</b> 启之泰 <b>东莞市启之泰电子科技有限公司</b>		
TOLERANCE	PROJECTOR	TITLE:
X. XXX X. XX X. X		Single row socket connector 2.54mm L=13.76mm 90°
±0.05 ±0.15 ±0.20	DATE: 2016-5-6	PART NO.: QZT1D1-RXXXXX1376A
±0.30 ±5.0°	DRAWN: TANG-S-G	DRAWING NO.: 20160050603
ANGLE	CHECKED:	REV: A0
	APPROVED:	UNIT: mm
		SCALE: FULL
		SIZE: A4